



Class 1-2 Utility Torque Tool (API 17D)

Ideal for low torque valve operations

This torque tool has been specifically developed to provide the highest level of performance. It has integral torque and turns counting sensors for closed loop control. When matched with a PSS supplied torque tool control manifold, it can provide precise feedback on torque response of any subsea operation. These can alternatively be utilised by connecting a PSSL universal subsea display, which would give a visual read-out of live torque feedback and/or turns counter. USD sold separately.

The tool conforms to the ISO 13628-8 fig 18 class 1-2 bucket interface used extensively in the subsea industry for valve overrides operated by ROV. The tool can also be supplied with a socket to operate paddle and t-bar style interfaces to ISO 13628-8 fig.13 (a), (b), (c).

The sensor section directly measures the torque between the reaction lugs of the tool and the driven shaft. The sensor is a strain gauge bridge optimised for torsion measurement. When the tool is fitted with the paddle type socket, the torque reaction is taken through the manipulator handle but still measured by the sensor.

Applications

Class 1-2 valve operations
Paddle valve operations

Features

ISO 13628-8 fig 18 (API 17D) class 1-2
Max torque 160Nm / 120ft lbs
Dual sensor electronic turns counter
Internal strain gauge

In the box

Class 1-2 utility torque tool
Class 1-2 socket
Paddle / T-bar socket
Bladder style compensator
Fish tail handle
Operational hoses
Operations and maintenance manual



Class 1-2 Utility Torque Tool (API 17D)

Specifications



Torque interface	ISO 13628-8:2001 (E) fig 18 & fig 13
Torque range	30-160Nm / 22-120ft lbs
Typical repeatability	+/- 6% (repeatability variation at full load)
Socket sizes	1 1/16" sq class 1-2 socket paddler/T-bar to ISO fig 13 socket
Weight in air	36kg / 79.3lbs
Weight in water	18kg / 39.6lbs
Electrical connector	8 pin burton
Sensors	Dual sensor inductive turns count sensor
Hydraulic	Mineral oil

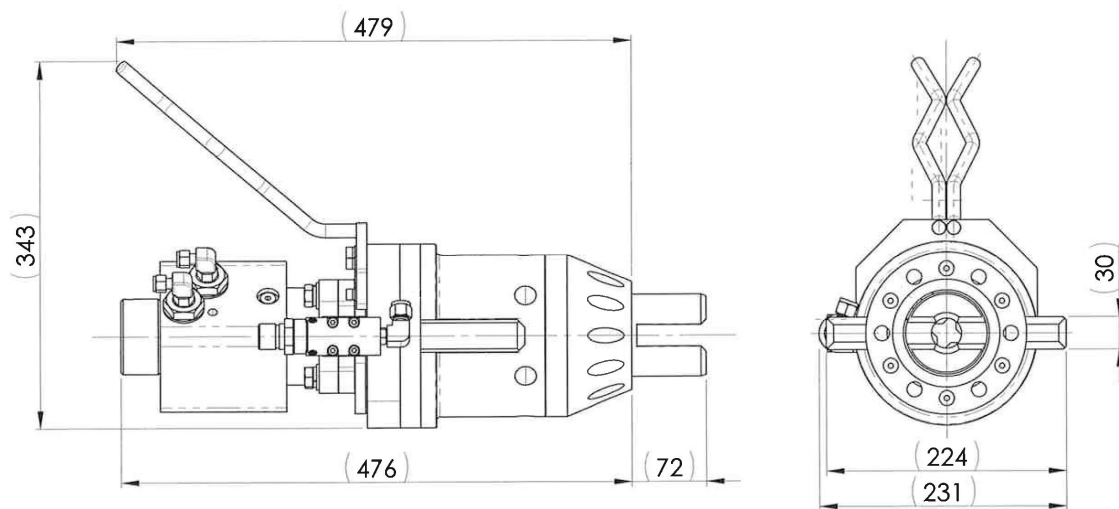

Aberdeen
+44 (0)1224 771888

Abu Dhabi
+971 2 650 7710

Houston
+1 281 398 9533

Singapore
+65 6545 9350