



Manipulator Operated Torque Tool

Ideal for manual valve operations

The tool is used to operate ISO Class 1-2, 3 or 4 interfaces without the use of a torque tool. The tool utilises the rotate function on the manipulator to generate the required torque.

Applications

Manual valve operations

Features

ISO 13628-8 fig 18 (API 17D) class

1-2

Direct manipulator operation

Stainless steel construction

Class 1-2, Class 3, Class 4

High torque

In the box

Manipulator operated torque tool

Operations and maintenance manual

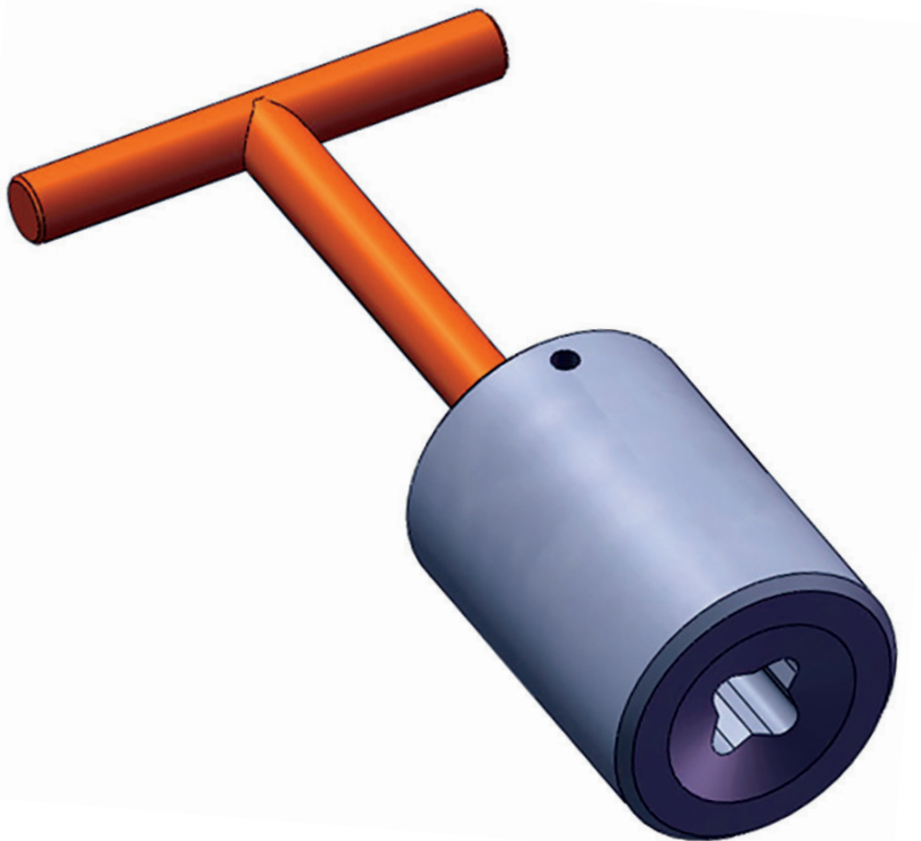

Manipulator Operated Torque Tool

Specifications



Interface	ISO 13628-8 fig 18 class 1-2, 3 or 4 socket
Maximum torque	Dependant on manipulator
Materials	Stainless steel
Weight in air	3kg / 6.6lbs
Weight in water	2kg / 4.4lbs

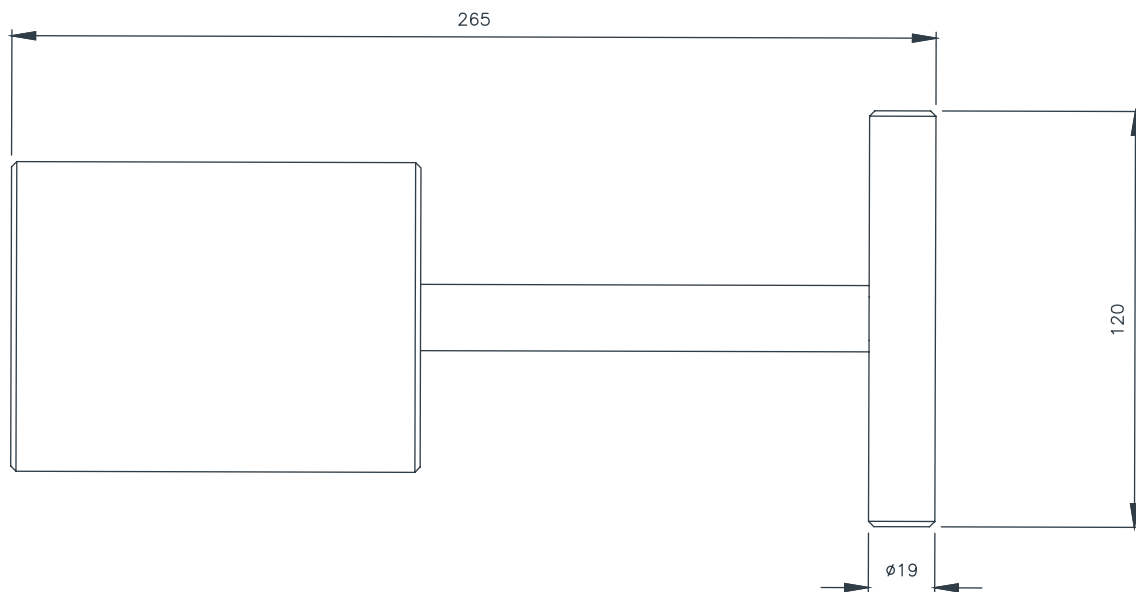

Aberdeen
+44 (0)1224 771888

Abu Dhabi
+971 2 650 7710

Houston
+1 281 398 9533

Singapore
+65 6545 9350